

Load Class
up to C250
EN-1433 Standard

HYDRO

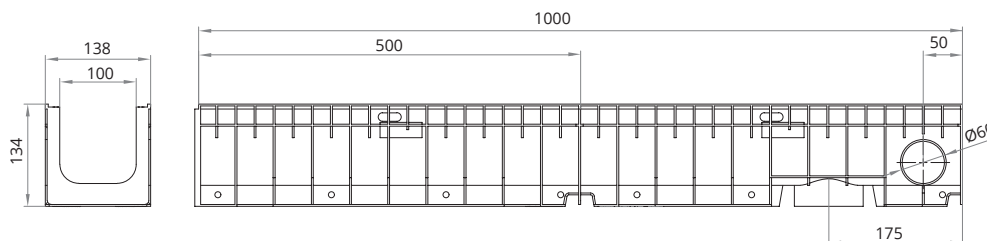

ULMA Linear Drainage Channel, type HYDRO: External width 138mm; Internal width 100mm and overall height 134mm, to collect rain water in 1 metre long units. Locking system consists of locking bar and screws.



CHANNELS

Code Channel	L mm	H mm	Width mm		Ø Outlet* mm		Hydraul. Section cm ²	Pcs. pallet	Weight Kg	Qref l/s
			Ext.	Int.	Vert.	Hor.				
HYDRO	1000	134	138	100	90	60	97	90	1,4	3,66

GRATINGS

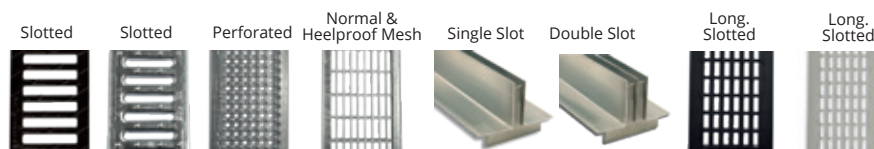

HOW TO FIX

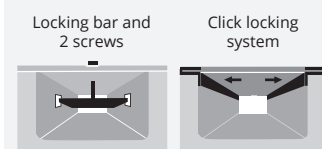

Material	Design	Load	Code	L mm	Width mm	Opening Ø	Weight Kg	Intake area cm ² /ml	Code	Units ml
	SLOTTED	C250	FNX100UCCM	500	130	13	2,7	435	TEF840 + CS100	2 + 2
GALVANISED STEEL	SLOTTED	A15	GN100UCA	1000	130	9	1,6	268	TNPC850 + CS100	2 + 2
	PERFORATED	A15	GP100UCA	1000	130	Ø6	1,4	159	TNPC850 + CS100	2 + 2
	MESH*	B125	GEX100UCB33	1000	130	30 x 30	3,2	837	TEF840 + CS100	2 + 2
	HEELPROOF MESH *	B125	GEHX100UCB	1000	130	30 x 10	0,8	749	TEF840 + CS100	2 + 2
	SLOT	C250	GR100UOC	1000	130	15	2,8	150	(1)	(1)
	DOUBLE SLOT	C250	GDR100UOC	1000	130	2 x 12	5,5	240	(1)	(1)
STAINLESS STEEL	SLOTTED	A15	IN100UCA	1000	130	7	1,5	218	TXNPC850 + CS100INOX	2 + 2
	PERFORATED	A15	IP100UCA	1000	130	Ø6	1,7	651	TXNPC850 + CS100INOX	2 + 2
COMPOSITE	LONG. SLOTTED BLACK	A15	PNLH100UCAM	500	130	8	0,4	367	TXE840 + CS100INOX	2 + 2
	LONG. SLOTTED GREY	A15	PNLH100UCAM-GRIS	500	130	8	0,4	367	TXE840 + CS100INOX	2 + 2

* Available in stainless steel, consult design

(1) Click. Without screws.

OPEN END CAP

Code	Ø mm	
TH100A	90	

CLOSED END CAP

Code	
TH100C	

LEAF GUARD

Code	
FS90	